

UF | UNIVERSITY *of* FLORIDA





THE HUB

**BIKE
PARKING**

**CSE/MARSTON
PLAZA**

**ALACHUA
SCULPTURE**

CSE

MARSTON

NEWELL DRIVE

**REITZ UNION
LAWN**

Location

THE HUB

BIKE
PARKING

MARSTON

Existing CSE/Marston Plaza Area



An aerial photograph of a campus, showing several large, interconnected buildings with flat roofs. There are numerous trees scattered throughout the area, particularly in the lower-left and lower-right quadrants. A road or path runs along the right side of the buildings. The overall scene is a typical university or institutional campus layout.

The MGC Monument must:

- Fit into the existing plaza area
- Accommodate up to 50 people
- Be an appropriate scale for its space
- Be highly visible

Design Criteria

THE HUB

MARSTON

CSE/Marston Plaza Area Modification



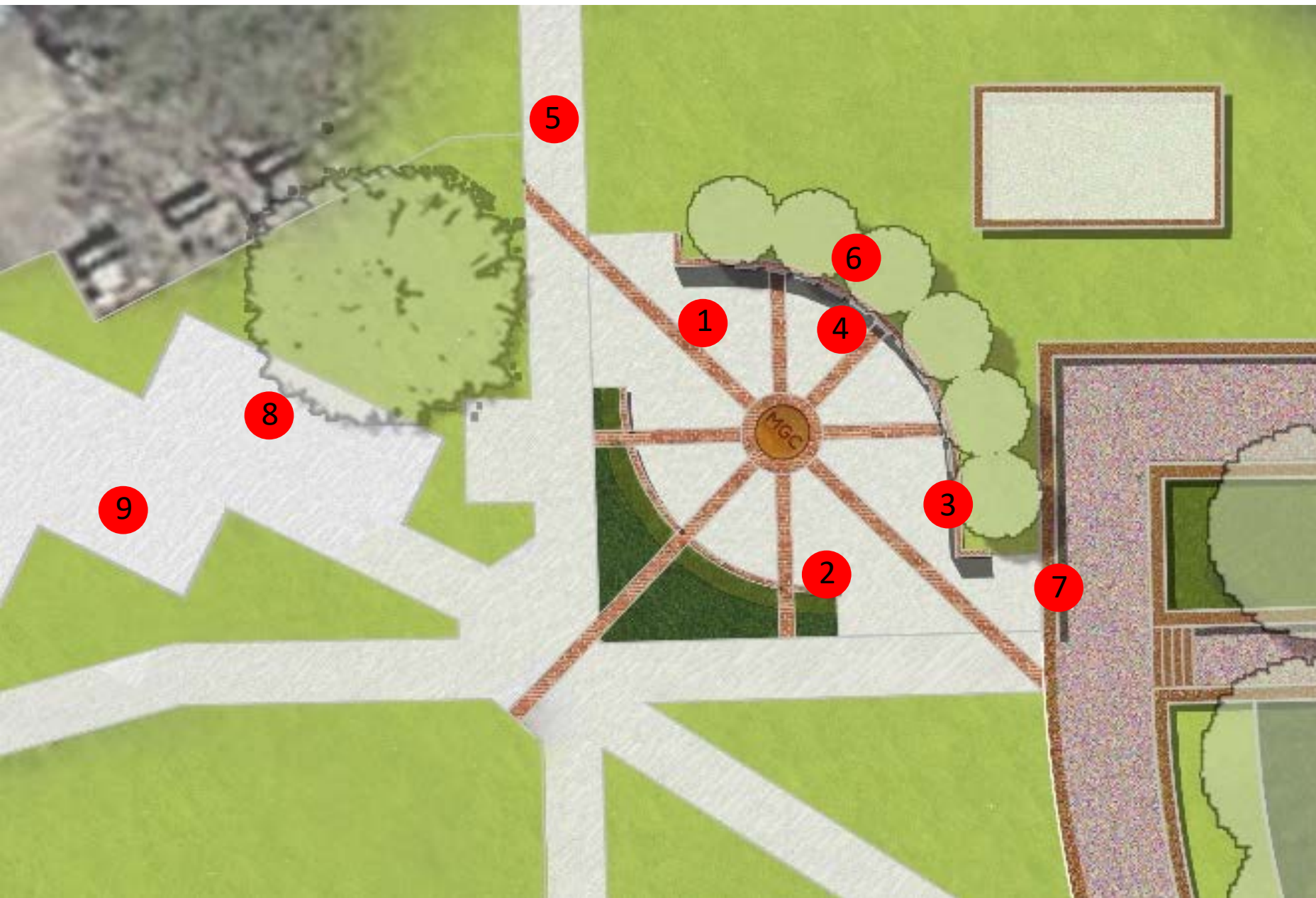

- 1 Brick Paving
- 2 Brick Seat Wall
- 3 Concrete Paving
- 4 MGC Monuments
- 5 Existing Paving
- 6 6' Brick Wall
- 7 Memorial Plaque
- 8 Proposed Bicycle Area
- 9 Existing Bicycle Area

Proposed Design



Proposed Design



Proposed Design



Proposed Design



**Sigma Lambda Beta
International Fraternity, Inc.**

Zeta Beta Chapter

**Founding Date:
April 4, 1986**

**Charter Date:
January 30, 1999**



**Lambda Theta Phi
Latin Fraternity, Inc.**

Phi Chapter

**Founding Date:
December 1, 1975**

**Charter Date:
March 5, 1995**



**Lambda Theta Alpha
Latin Sorority, Inc.**

Chi Chapter

**Founding Date:
December 1, 1975**

**Charter Date:
March 17, 1996**

Proposed Design